



Address 123 1000 Glenhaven Way, Cochrane, AB
Date April 27th, 2023
Name Kathleen Burk | Remax Realty Professionals
Email kathleenburk@remax.net
Phone 403.818.8049

FLOOR TOTALS

Main Level	1330.99 sqft / 123.65 m2	RMS Total	1330.99 sqft / 123.65 m2
Upper Level	000.00 sqft / 000 m2	Total w/ basement	2564.88 sqft / 238.28 m2
Basement Total	1233.89 sqft / 114.63 m2	Order Procedure	RECA RMS
Finished Basement	1010.84 sqft / 93.91 m2	Exterior Wall Size	NA
		Order Type	Attached Single Family



ROOM DIMENSIONS

Kitchen	14'4" X 12'2" ft/in	M	Laundry	9'8" X 8'10" ft/in	M
Dining Area	12'2" X 11'4" ft/in	M	Deck	21'0" X 9'0" ft/in	M
Living Room	21'0" X 14'10" ft/in	M	Garage	23'10" X 19'6" ft/in	M
Foyer	6'4" X 5'8" ft/in	M	Utilities	18'10" X 13'0" ft/in	B
Den	10'2" X 9'8" ft/in	M			
Rec Room	14'6" X 11'0" ft/in	B			
Family Room	30'10" X 15'2" ft/in	B			

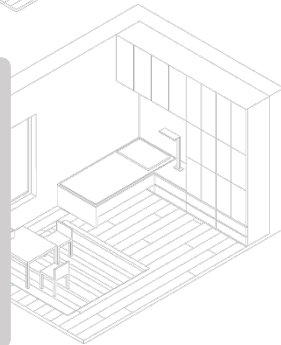

BEDROOM DIMENSIONS

Primary Bedroom	14'2" X 11'6" ft/in	M	Bedroom Four	0'0" X 0'0" ft/in	NA
Bedroom Two	11'4" X 10'10" ft/in	B			
Bedroom Three	0'0" X 0'0" ft/in	B			

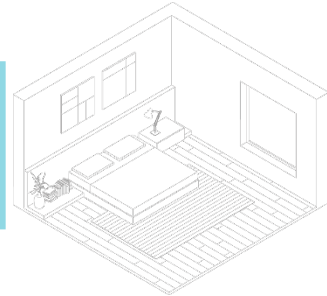

BATHROOM PIECES AND ADDITIONAL ROOMS

Two Piece	5'6" X 5'2" ft/in	M
Four Piece (Ensuite)	10'6" X 8'8" ft/in	M
Four Piece	12'2" X 5'6" ft/in	B

